

Does snow affect solar panels?

Snow can act as a way to clean your solar panels (for free)! When it melts, it takes any dirt or debris along with it. Overall, snow should not dramatically impact solar panels or how they work in the winter. Just keep in mind that if the snow does not slide off or melt for a few days, at that point your panels might not generate electricity.

Can solar panels generate solar energy if it is covered in snow?

Solar panels cannot generate solar energy if they are covered in snow. The good news is that you can eliminate this issue by either waiting for gravity to do its job and having the snow fall off or waiting for it to melt. Another option is cleaning them off yourself.

Should solar panels be buried in snow?

Solar panels need direct sunlight to generate electricity effectively. By removing snow, you enable the panels to resume optimal energy production. Maximizing Energy Output: When solar panels are buried in snow, they produce less electricity or might not work.

Can solar panels withstand snow?

The anti-soiling properties of snow inherently make solar panels cleaner and able to reach higher efficiencies. SunShot is exploring other ways to help PV panels withstand the elements of winter through our support of the DuraMat Consortium, led by the National Renewable Energy Laboratory.

Why is removing snow from solar panels important?

To prevent these issues, removing snow from solar panels is crucial. It ensures that the panels can resume optimal operation quickly and maximize energy production, especially during the limited sunlight hours of winter. This is vital for maintaining a steady and reliable energy supply for homes and businesses that depend on solar power.

Can solar power work in snow?

Tackling weather-related challenges is one reason why the SunShot Initiative funds Regional Test Centers, where solar panel performance can be time-tested in widely varying climates. Researchers at the

# DOES SNOW BLOCK SOLAR PANELS



test centers have shown that solar can still successfully generate electricity in snowy areas and other harsh environments.

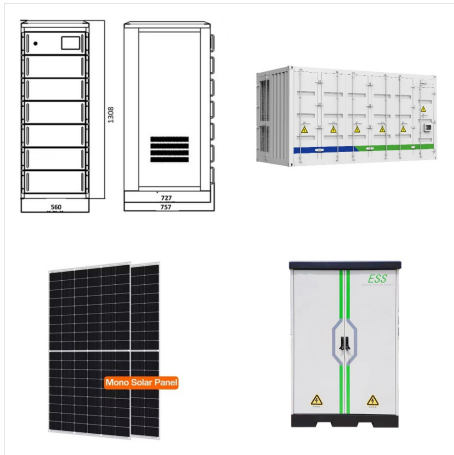

Solar panels covered in snow do work, but there's a catch: only a light dusting of snow allows them to generate energy. Therefore, we recommend speeding up the melting process. While a heavy blanket will significantly block sunlight. Do solar panels produce less in winter? Yes, even in sunny weather. Winter days are naturally shorter than

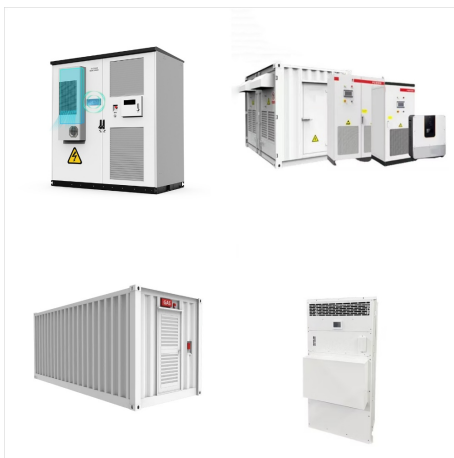

Here, we discuss how winter and snow impact solar panels. Go to Homepage. But this happens because a thick layer of snow blocks sunlight. As the snow melts away from the surface, solar panels



8- Solar Panel Snow Rake. If you want to remove snow on solar panels without risking damage, you can do so with the help of a solar panel snow rake. These rakes are specially designed to remove snow from solar panels without causing any unnecessary damage. They can be used on almost any type of roof, too.

# DOES SNOW BLOCK SOLAR PANELS

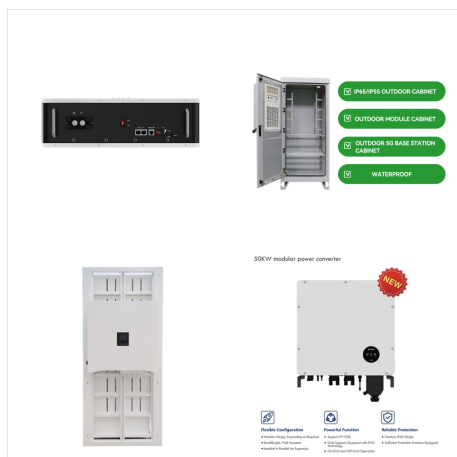

How Does Snow Affect A Solar Panel? A light layer of snow on the panels will marginally affect its ability to generate electricity. At the same time, if there is a snowstorm and the panels have a thick layer of snow on them, this will block out the sun and produce no electricity.



The Risks of Snow Accumulation on Solar Panels Performance Hindrance. Snow on your solar panels can reduce power output. As snow piles up, it blocks light from reaching your solar cells. Even a thin layer can impact power generation. Property Damage Risks. Heavy snow sliding off solar panels can cause harm to property and people.



These solar panels capture light energy from the sun and convert it into electricity that can be used by the people inside. Some power companies use solar panels as a source of electricity, too. However, clouds can block light from the sun. So, do clouds affect the creation of energy by solar panels?

# DOES SNOW BLOCK SOLAR PANELS

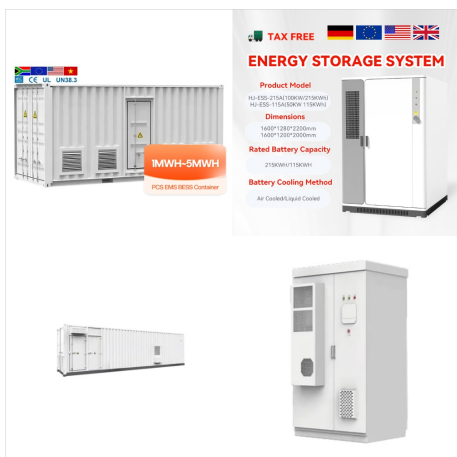

Snow guards block your panels from excessive snow accumulation, while the panel's steep angle allows precipitation to slide naturally from the roof. Potential Consequences of Reduced Efficiency  
Neglecting maintenance and leaving snow on solar panels may cause your panels to become less productive.



How To Clear Snow From Solar Panels. Cleaning snow from solar panels is an uncomplicated task, but whenever you do so, be careful. Snow-covered roofs will be slippery, and you can sustain a significant injury if you fall. Wait It Out. If you've had a little snow, but the sun is on its way out, you can wait for your panels to heat up.



As we know, solar panels absorb sunlight to produce energy, although this is not possible with snow-covered solar panels. So, how do we go about removing snow from the solar panels? That's what we'll cover here today and these other key points; Dangers of snow on solar panels; What happens when snow is on solar panels; Preventing snow on

# DOES SNOW BLOCK SOLAR PANELS



Here is how shading, cloudy weather, rainy days, and snow affect solar panel performance. Updated 2 months ago Do solar panels need direct sunlight to work? A heavy accumulation of snow, on the other hand, would block sunlight and greatly reduce energy production. The good news is that this situation rarely occurs: solar panels are great at



**How Do Solar Panels Work in Winter With Snow?**  
Solar panels can still generate electricity even when covered with a layer of snow. However, the power output will be significantly reduced due to the lack of direct sunlight. Clearing the snow allows panels to absorb sunlight, restore optimal performance, and maximize energy generation.



Not only can snow clean solar panels as it melts, it can also reflect sun back onto the solar panels, increasing energy production. Ice: Ice normally does not cause problems for solar panels. Since ice is clear, it does not block sunlight and allows solar panels to continue electricity production. A problem can arise if ice finds its way into



# DOES SNOW BLOCK SOLAR PANELS



Do solar panels work in the winter? Even though there are fewer sunlight hours in the winter, as long as there is some sunlight out, your solar panels will still be able to collect that energy. Additionally, solar panels work more efficiently in the cold. As mentioned before, it's important to keep your solar panels clear from any snow



How does weather affect solar panels? Find out in our easy-to-understand guide. Uncover the impact of sun, rain, wind, and snow on your solar energy output. On one hand, a layer of snow can block sunlight and reduce power output. On the other hand, the reflective properties of snow can actually increase the amount of sunlight hitting the



How do solar panel snow guards work? Another product is the Solar Snow Dog, which is a 6-inch block made from aircraft-grade aluminum that can be used in both portrait and landscape orientations. This product allows the snow to slide off your panels, although in a slower and more controlled manner.

# DOES SNOW BLOCK SOLAR PANELS



Other ways to clear and keep snow off your solar panels. In addition to automated solutions, there are a number of other ways you can clear and keep snow off your solar panels. 1. Manual Removal: This is usually the simplest and safest way to clear snow from your solar panels. You can use a soft-bristled brush, a non-abrasive cloth, or a



Snowfall: Snow can block sunlight from reaching the solar cells, leading to reduced energy production. However, some studies suggest that the reflective properties of snow can enhance solar irradiance when panels are partially covered, partially compensating for the reduced direct sunlight. Answer: No, solar panels do not produce more power



Non-restricted solar panels shed snow. This allows the engineer to reduce the roof snow load further based on roof pitch and other factors that vary (see ASCE 7-16) up to as much as 37%. Using the example above, this means by adding solar panels to the roof at 2-4 psf you actually reduced the loads that the roof was originally designed to

# DOES SNOW BLOCK SOLAR PANELS



Do Solar Panels Operate in Cold Temperatures?  
Yes! Solar panels rely on light and not heat so they'll still operate even in cold winter temperatures.  
Manage Snow or Debris. Snow and debris can block sunlight and reduce energy production so ensure you keep your panels clean for maximum output. Panels that are angled between 30-45 degrees



Solar panels can work extremely well in snow ??? except if the snow is so heavy that it covers them. If snow blocks daylight from reaching your panels, it'll have the same effect as an overhanging tree branch, bird droppings, or any other debris.



It collects snow from the solar panels. The fence can also block the snow that keeps accumulating on the solar panels. Do you need a solar snow protection device? Solar snow protection devices are primarily suited for areas where snow falls regularly in the winter. Of course, even if it doesn't snow often in the winter, you can still choose



# DOES SNOW BLOCK SOLAR PANELS



**Removing Snow from Solar Panels:** In general, solar panels require minimal maintenance. But if your area receives heavy snow, you will need to stay on top of snow removal to keep your system functioning at maximum efficiency. Heavy snow brings a few issues to your solar array. The snow can block out sunlight, reducing the efficiency of your



A solar panel's performance can be affected by anything that blocks it, so it's critical to learn how to keep snow off solar panels. Meanwhile, you might find this video about solar panel snow removal informative and helpful: [Do Solar Panels Work When Covered With Snow](#). Yes. However, don't expect your solar panels to produce as much



With winter fast approaching, many people are asking how does snow affect solar panels? So here is the problem, if a lot of snow covers your solar panel, then it will block sun rays and reduce the light receiving area. Generally speaking, the more snow that accumulates on PV panels, the higher its insulating effect will be.

# DOES SNOW BLOCK SOLAR PANELS



So it surprises many people to hear that while, yes, a thick layer of snow can block solar panels from absorbing any sunlight for a while, panels don't usually stay snow-covered for long. Panels from firms like AEI or elsewhere operate at a warmer temperature than the outside air, which helps to melt the snow off and in fact, recent research



Snow accumulation on solar panels can block sunlight and significantly hinder power generation. Therefore, regular snow removal is critical for maintaining the efficiency of your solar system. However, it is important to clear the snow with proper techniques and equipment to avoid damaging the panels.