



We are a leading smart video doorbell manufacturer offering smart security products. Technical Support: 01291446105 (Mon to Fri 8am to 4pm) or E-mail: support@ener-j.uk ; Shop by product code; Need help ; Call 24/7 on: ???



info@ener-j.uk; Payment Icons. ENER-J SMART LTD - Visit Out Website. We are a team of passionate people whose goal is to improve everyone's life through disruptive products. We build great products to solve your business problems. Our products are designed for small to medium size companies willing to optimize their performance.



Smart Wi-Fi Panel Heater, Tempered Glass 2000W; Public Pricelist TEST 50; MIDA 40%; direct trade; Previous Next. Smart Wi-Fi Panel Heater, Tempered Glass 2000W info@ener-j.uk; Payment Icons. ENER-J SMART LTD - Visit Out Website.

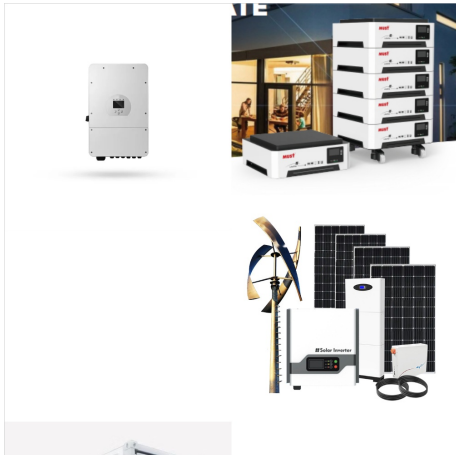

Several Applications: ENER-J's LED tape strip can be used for decorating your home (e.g. dining room, bed room, upstairs, kitchen, porch, desk, and living rooms, especially great for holidays and events like Christmas, Halloween, ???



ENER-J SMART LTD - Visit Our Website. We are a team of passionate people whose goal is to improve everyone's life through disruptive products. We build great products to solve your business problems. Our products are designed for small to medium size companies willing to optimize their performance.



ENER-J SMART LTD - Visit Our Website. We are a team of passionate people whose goal is to improve everyone's life through disruptive products. We build great products to solve your business problems. Our products are designed for small to medium size companies willing to optimize their performance.



info@ener-j.uk; Payment Icons. ENER-J SMART LTD - Visit Our Website. We are a team of passionate people whose goal is to improve everyone's life through disruptive products. We build great products to solve your business problems. Our products are designed for small to medium size companies willing to optimize their performance.



Smart Wi-Fi touch switch comes with 2 gang with no neutral required. Shop now. Technical Support: 01291446105 (Mon to Fri 8am to 4pm) or E-mail: support@ener-j.uk ; Shop by product code; Need help ; Call 24/7 on: 03330 112 112 ; 0. Checkout; Login; Wireless Switches ENER-J SMART LTD, Unit 11D, Cosgrove Way, Luton LU1 1XL ; Email:



ENER-J's Wi-Fi Smart Plug connects to the Internet through WiFi network and controls the power of home appliances, smart phone or any other device. It can control the switch of plug and track the status of plug at any place where network is available on your smart phone. ENER-J SMART LTD, Unit 11D, Cosgrove Way, Luton LU1 1XL ; Email



HD Quality Imaging: Guard your property with this 1080P HD Quality Wireless Camera. Keep a watch on your property remotely via your APP. ULTRA LOW POWER TECHNOLOGY - This smart network solar camera is powered by solar energy and battery, ultra-low power consumption, it also has a low-power reminder function.; PIR MOTION DETECTION - It supports PIR ???



Ener-J is the London & Europe's #1 Consumer Service provider for Smart Home Automation, Home Security Systems, Wireless Switches, Infrared Heating Panels, Electrical Accessories, Smartplug, Ledstrip, Smartliving, Wifibulb, Doorbell, Ledlighting and IPCamera. ENER-J SMART LTD, Unit 11D, Cosgrove Way, Luton LU1 1XL ; Email: [info@ener-j.uk](mailto:info@ener-j.uk);



[info@ener-j.uk](mailto:info@ener-j.uk); Payment Icons. ENER-J SMART LTD - Visit Out Website. We are a team of passionate people whose goal is to improve everyone's life through disruptive products. We build great products to solve your business problems. Our products are designed for small to medium size companies willing to optimize their performance.



Equipped with a 360 ° overview, the camera is perfect for monitoring large spaces such as sales floors, warehouses, offices, small shops, buses, and other vulnerable areas such as showrooms, living rooms, master bedrooms, and a lot more. 1.3MP resolution 360 degrees panoramic view; Wireless connection (Wifi not support 5G) Support Motion detection



info@ener-j .uk; Payment Icons. ENER-J SMART LTD - Visit Our Website. We are a team of passionate people whose goal is to improve everyone's life through disruptive products. We build great products to solve your business problems. Our products are designed for small to medium size companies willing to optimize their performance.

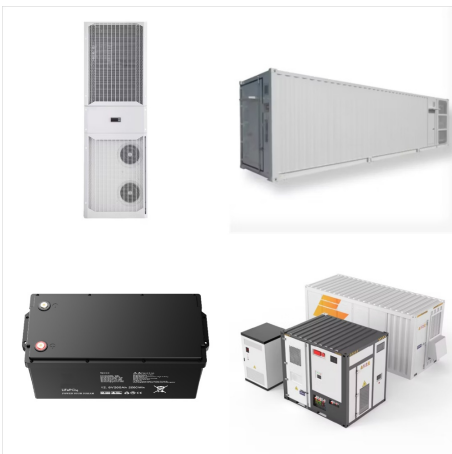

New tempered glass convection heater by ENER-J, the perfect heating solution that unites design and technology to meet the needs of your home. A jewel of design: clean heating, without smoke or gas, without noise, so that you can ???





ENER-J's Wi-Fi Smart Plug connects to the Internet through WiFi network and controls the power of home appliances, smart phone or any other device. It can control the switch of plug and track the status of plug at any place where ???



At Ener-J, we all are passionate about technology, innovations and wholesale business and are working continuously on products that touch everyone's life. Our goal is helping you save money, save energy and reduce your carbon footprint. With over 8 years' experience in innovative products such as LED Lighting, solar energy and other carbon reduction products, ENER-J ???



Ener-J is UK's leading smart home solutions brand offering more than 1000 smart home products and best home tech devices. Buy smart home products now with Ener-J. Call Us: Tel: +44 (0)151 272 0139 (Mon to Fri 8am to 5pm) or E-mail: support@enerjsmart.uk -60% Surface mounted SKY LED Ceiling Light, 2D Printed SKY Light Shade, Power: 24W



Outdoor hardwired smart plug-in socket which can also be voice controlled via echo dot or google home. IP55 waterproof designed Smart wifi Socket which can withstand damp and wet conditions. Being made with a sealing lid cover makes it perfect for for bathrooms, patio light and outdoor string LED lighting or fountains.



Several Applications: ENER-J's LED tape strip can be used for decorating your home (e.g. dining room, bed room, upstairs, kitchen, porch, desk, and living rooms, especially great for holidays and events like Christmas, Halloween, Parties). ENER-J SMART LTD, Unit 11D, Cosgrove Way, Luton LU1 1XL ;

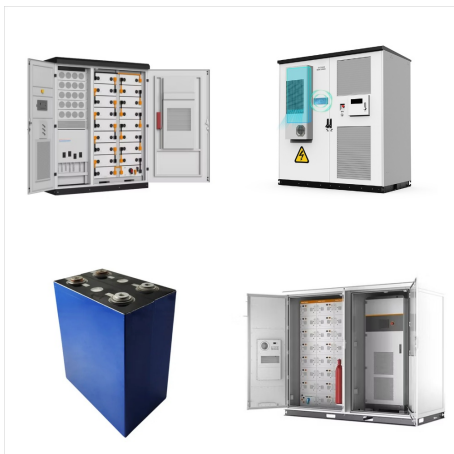

info@ener-j .uk; Payment Icons. ENER-J SMART LTD - Visit Our Website. We are a team of passionate people whose goal is to improve everyone's life through disruptive products. We build great products to solve your business problems. Our products are designed for small to medium size companies willing to optimize their performance.



More for ENERJ SMART LTD (10575127)  
Registered office address 11d Cosgrove Way,  
Luton, England, LU1 1XL . Company status Active  
Company type Private limited Company  
Incorporated on 20 January 2017. Accounts. Next  
accounts made up ???

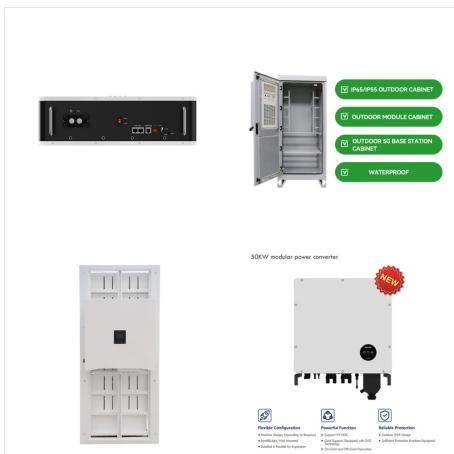

Set the temperature with the buttons on the  
front,your ENERJSMART app or by voice in  
combination with Google Home or Amazon Alexa  
Connects directly to your Wi-Fi so you can control it  
from anywhere in the world Simply set a timer or a  
schedule for automated heating The heater uses the  
full 1800 W to quickly heat up the room - and when  
approaching the target ???



ENER-J SMART LTD - Visit Our Website. We are a  
team of passionate people whose goal is to improve  
everyone's life through disruptive products. We build  
great products to solve your business problems. Our  
products are designed for small to medium size  
companies willing to optimize their performance.





info@ener-j.uk; Payment Icons. ENER-J SMART LTD - Visit Out Website. We are a team of passionate people whose goal is to improve everyone's life through disruptive products. We build great products to solve your business problems. ???



info@ener-j.uk; Payment Icons. ENER-J SMART LTD - Visit Out Website. We are a team of passionate people whose goal is to improve everyone's life through disruptive products. We build great products to solve your business problems. Our products are designed for small to medium size companies willing to optimize their performance.



Buy smart home products now with Ener-J. Ener-J - Smart Home Solutions, Buy Smart Home Products, Best Home Tech. Call Us: Tel: +44 (0)151 272 0139 (Mon to Fri 8am to 5pm) or E-mail: support@enerjsmart.uk -60% Surface mounted SKY LED Ceiling Light, 2D Printed SKY Light Shade, Power: 24W, Size: 300mm, 6500K, IP20