

Dynamic ESS l?dt Batterie nicht. Hallo zusammen,
Ich habe mir die neue Venus 3.30 aufgespielt um
den Dyn. Eis zu nutzen. Leider wird mein Akku jetzt
nicht mehr von Solar geladen. Meine Konfiguration.
3x 5000er AC in Stadtwerke AC Out komplettes
Haus. 14 KW Akku. Mppt mit zwei Solar Panels.



We continue our Cleantech for Baltics Coalition
introductions with Beamline Accelerator from
Estonia. ???? Beamline Accelerator is a dynamic
cleantech??? Liked by Hanna Ess EU cleantech
briefing for the first quarter of 2024 highlights a
historic debt investment boom that amounted to
???16.7 billion. ???? Cleantech for???



In case you are unfamiliar with Dynamic ESS:
Dynamic ESS is an algorithm that aims to minimise
the costs made on the grid and battery. Please
check the four previous posts on the subject for
further information. You can get started with it ???



Hallo zusammen, Ich nutze aktuell das ESS, und habe das nun den gesamten Sommer laufen lassen, damit sich das System an den Verbrauch assimiliert. Dies ist, wie bei euch allen vermutlich zu ungenau, da Wallbox und WP jedes mal die Prognose zerballern. Dennoch habe ich mit 20kwp Solar und 30kwh Akku mit 6x Multi Plus 5000 genug Power, um das Haus ???



Will the dynamic ESS be available on IOS VRM App. Maximale toegelaten laad- en ontlaadsnelheid van de accu. What are the use cases for DESS. HAN port on the home electricity meter as energy meter for Dynamic ESS. Summary of ???



Import the fetch-dynamic-ess flow (ctrl-i). Once imported, double-click the Dynamic ESS VRM node and fill out all required fields.. The imported flow looks like this: Note that there also exists another flow that you can import: fetch-dynamic-ess-with-average-price-switching.json. This flow shows how to switch on/off a relay based on the average (dynamic) price.

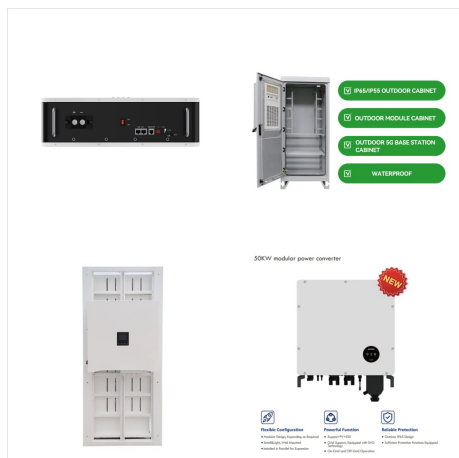

Dynamic ESS is an algorithm that aims to minimise the costs made on the grid and battery. Please check the three previous posts on the subject for further information. You can get started with it on beta-VRM via Settings ??? Dynamic ESS. There is a concept manual. All feedback can be provided below.



Note that there also is API type Dynamic ESS, but we don't use that yet. The VRM site id is the number that the API uses to identify which site to query. It is the number you also see in the URL when you are on the VRM dashboard of your site. So make sure that you have your own number there (your access token is restricted to only allow



With Dynamic ESS the same rules should apply, but the current costs (or the difference of the two) should be taken into account into the decision if charging/discharging the batteries is a good measure. This is an example what it currently looks like (both, one heatpump and one BEV are active loads, very weak solar intake, SOC below 50%)



hello all, First of all, I am not an expert on this, but I have been working with Victron hardware and software for about 2 years now. So I might be overseeing an very easy step ????? Yesterday I was at a friend's location, And within an hour or so we had Dynamic ESS (DESS) configured and running. Yet I can't get it to work (whe way I would expect) at my own place. ???



The updated "Energy" graph for Dynamic ESS offers a clearer and more precise view of your system's activity, both past and future. Previously, the graph included some simplifications to provide quick insights into Dynamic ESS operations. However, many users requested a more detailed breakdown of energy flows. In the previous version, solar ???



The Sally-class Cruise ferry is a ship added in the mini-update before U40, on May 3rd 2021. She was a community submission by EECaptain. The Sally-class Cruise ferry, MS Estonia, was a cruise ferry built in 1980 for the Finnish company Rederi Ab Sally by Meyer Werft, in Papenburg, West Germany. She was employed on ferry routes between Finland and Sweden by various ???



Dynamic ESS. Q& A and troubleshooting. 3-phase, domestic, beginner, dess. guich27 (Esteban Guichard) 7 December 2024 11:10 5. Multi RS Solar Firmware version v1.17 - VM-3P75CT DIY. Can anyone enlighten me as to what the support for the VM-3P75CT is on the new 1.17 firmware?



ESS - Planung der Ladung - keine Frage sondern ein Vorschlag. ESS Verst?ndnissfrage "Optimiert (Batterylife) ESS Konfiguration Deutschland. Rundsteuerempf?nger. MultiPlus II 48/5000/70-50 mit Einspeiseberenzung, Scheinleistung > 4,6 kVA

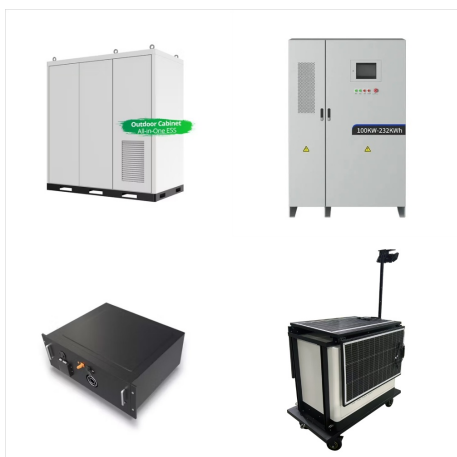

Hi all I recently set up Dynamic ESS with Octopus energy At first it seemed to work showing the electricity prices night rate (2:00 to 5:00am) and peak rate (16:00 to 21:00) What i noticed is that if there is not enough PV to fully charge the batteries it won't charge the batteries at the scheduled charge times 02:05 for 2:54 hours but rather like to charge the ???



Dynamic ESS zm??na !!! M?m FIX s n?zkou
sazbou 01-06 hod a 18-21 hod a zak?zan? prodej, a
hle dob?jen? Aku by prob?halo p??esn?? v t??chto
??asech, a nebere to ceny OTE (to je ok - m?m FIX
- a umysl?? velk? rozd?l mezi cenami) Zato energii
z AKU modr? ???st bere v ??asech vy????? ceny
FIXU . (Ot?zka zda to vydr? 3/4 ?, m?m jen 10



Hello, I also want to try the dyn. ess beta with the
austrian EPEX Spot(R) AT dynamic prices. But if I
choose in the list "Austria" there is no EPEX spot
offered, Dynamic ESS beta discussion. Dynamic
ESS GitHub . Dynamic ESS DRAFT documentation.
End user custom DESS implementation (Andy156)
question details. 42 People are following this



Starting today UK Octopus users are able to use
regular VRM to configure and use Dynamic ESS. It
uses the Octopus API, enabling you to use Dynamic
ESS with any Octopus-supported energy contract.
Setting up Dynamic ESS in the UK is
straightforward. All you need is your Octopus API
key, which you can easily obtain by following the
steps in this video. In ???



Dynamic ESS intelligently switches between battery storage, solar energy, and the electricity grid. Based on "input data" and "learning" it optimally stores low-cost energy for use when prices are high.



victron-dynamic-ess 0.1.23. Fetch the ideal ESS setpoint from VRM. npm install victron-dynamic-ess. Dynamic ESS. A Node-RED flow that uses VRM forecasting and algorithm to optimize when to sell, buy and hold the grid to zero. For use in systems that have hourly day ahead prices, which is the case in a big part of Europe.



The updated "Energy" graph for Dynamic ESS offers a clearer and more precise view of your system's activity, both past and future. Previously, the graph included some simplifications to provide quick insights into Dynamic ???



Thanks to its integration with the Octopus API, Dynamic ESS is compatible with any Octopus-supported energy contract. Setting up Dynamic ESS in the UK is straightforward. You'll just need your Octopus API key, which you can obtain easily by following the steps in this video. For more information on Dynamic ESS, please refer to its user manual.



I've set up a Dynamic ESS using the Cerbo GX and one Multiplus II 48. Connected to the Beta VRM portal and using the Zonneplan dynamic energy. The grid is measured 3 phase. The buy and sell functions work fine. However in Auto I don't understand the behaviour. I'm missing the energy graph on the energy tab of the Dynamic ESS.