

A New View of the Universe. How did a telescope become a household name and change how we look at the cosmos forever? With over 1.5 million observations and 20,000+ papers published on its discoveries, Hubble is the most productive science mission in the history of NASA. Yet the story of Hubble's success starts before NASA even existed.

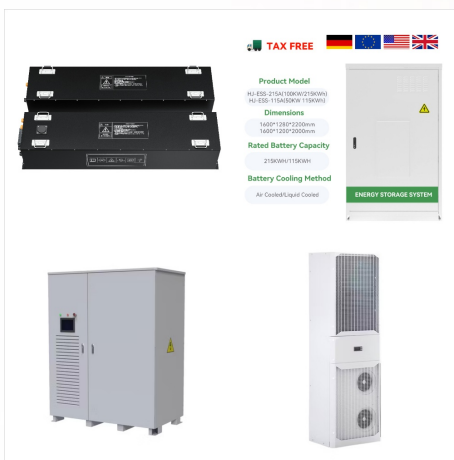

ViewSpace gives you the opportunity to explore our planet, solar system, galaxy, and universe. Provided free with the support of NASA, ViewSpace is developed by a team of scientists, educators, and communication specialists who collaborate to ensure that content is accurate, up-to-date, engaging, relevant, and accessible to a wide audience.



The NASA Worldview app provides a satellite's perspective of the planet as it looks today and as it has in the past through daily satellite images. Worldview is part of NASA's Earth Science Data and Information System. ESDIS makes the agency's large repository of data accessible and freely available to the public.

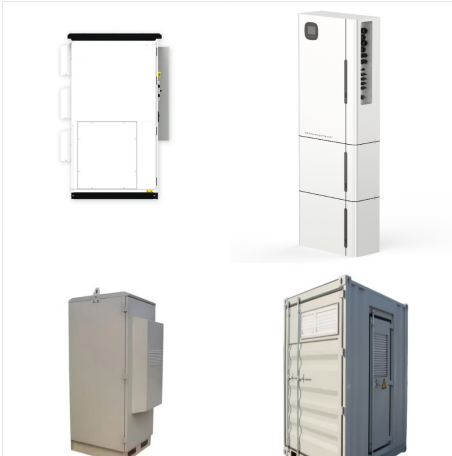

The videos tell the stories of the planets, stars, galaxies and universe, giving viewers the opportunity to experience space and Earth as seen with satellites and telescopes. Resources are available to make ViewSpace accessible to museums, science centers and ???

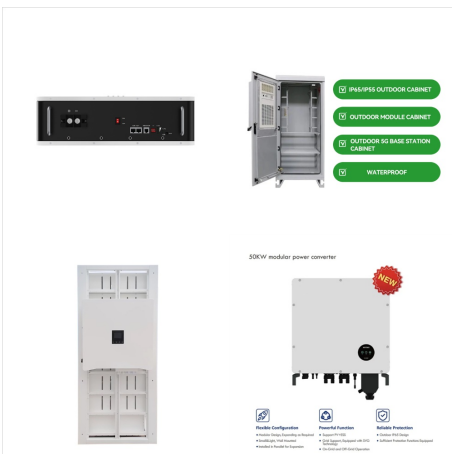

The Long View (2013): The true???and vast???complexity of the universe was captured in this vista recorded by a pair of automated telescopes, one in the U.S. and one in the Chilean desert. From



Webb's sharp near-infrared view brought out faint structures in extremely distant galaxies, offering the most detailed view of the early universe to date NASA and its partners will release the full series of Webb's first full-color images and data, known as spectra, Tuesday, July 12, during a live NASA TV broadcast



Celestia lets you explore our universe in three dimensions. Celestia simulates many different types of celestial objects. From planets and moons to star clusters and galaxies, you can visit every object in the expandable database and view it from any point in space and time. The position and movement of solar system objects is calculated



Our view of the universe will never be the same. The light that is visible to us represents a tiny slice of the light that's in the universe. Humans perceive different types of light as



Grab a ticket to view the spectacular Paisley Halloween Festival parade from the comfort of our covered grandstand seating area. A spectacular, 300-strong parade will wind through Paisley town centre each night, featuring professional performers, festival favourites ??? including PyroCeltica and Spark!



The deepest infrared view of the Universe ever was just unveiled, and it's even better than we could have imagined. In a NASA livestream, US President Joe Biden released the first official image from the James Webb Space Telescope (JWST), showing us an unprecedented new image of a region of space known as SMACS 0723 ??? a deep field into the distant Universe.



Stunningly beautiful book of "A View of the Universe." Malin's astro-photographs are in many books, including "The Cambridge Atlas of Astronomy," which see. Many used copies at fair prices but beware- I had to order three of these books before I got a complete copy- people cut pages and pictures out of this book.



Scale of Universe is an interactive experience to inspire people to learn about the vast ranges of the visible and invisible world. About us Resources Create with Us! Wiki Objects Community. Hello! Enter your email to subscribe to our newsletter! We have some big things coming and you don't want to miss out. ????????



First seen in 1987, this supernova (dubbed SN 1987A) was the brightest supernova and nearest one to Earth in the last century. In a supernova explosion, a massive star runs out of fuel then collapses onto their core, flinging the outer layers of the star into space.



We are a way for the universe to know itself." Improved Night Sky view. Added Milky Way Galaxy. Added More Objects to the Search List. Added Distance Meter. Added More Options. Added Fluent Movement through Cosmos. Added Manual Search for objects. 2018 June - Web Release. Added Astronomy Places page.



Developed by a team of scientists, educators, writers, and designers working closely with NASA missions, ViewSpace videos feature the latest imagery from satellites and space telescopes, and provide unique insight into our understanding of the universe. The ViewSpace video library is ???





The Hubble Skymap puts the night sky at your fingertips any time of day. Roam the Milky Way to find a selection of galaxies, stars, nebulae and more, and click for a Hubble's-eye-view of each object. To explore the skymap, scroll, double ???



Expand Your Universe with ViewSpace Interactives. ViewSpace Interactives allow you to explore objects and materials from different perspectives, and discover how we can combine information to better understand the universe. On the desktop view, the key features of the sample interactive are called out with numbers in yellow circles and



Discover how the universe works, explore how it began and evolved, and search for life on planets around other stars as we seek to understand the universe and. View All Topics A-Z; Home; Missions; Humans in Space; Earth & Climate; The Solar System; The Universe; Science; Aeronautics; Technology; Learning Resources; About NASA; Espa?ol;



A world map of the positions of satellites above the Earth's surface and a planetarium view Solar System Scope Model A model of the Solar System, Night sky and Outer Space in real time, with accurate positions of objects propelling our understanding of the universe, our solar system and ultimately, our place within it.



This map shows a slice of our Universe. It was created from astronomical data taken night after night over a period of 15 years using a telescope in New Mexico, USA. We are located at the bottom. At the top is the actual edge of the observable Universe. In between, we see about 200,000 galaxies. The full map is actually a sphere.



NASA's Visual Universe. To celebrate 60 years of NASA and 50 years of Project Apollo, the Google Arts & Culture Lab has created NASA's Visual Universe - an experiment drawing on NASA's vast image archive.. Using NASA's public API, we explored 127,000 historic images stretching back to 1915, and analyzed them using machine learning - bringing surprising and ???



SpaceEngine is a realistic virtual Universe you can explore on your computer. browse an interactive map of the surrounding space and view a map of the current planetary system. Save locations. and name objects. Save a favorite point in space and time and share it with friend. Give a name to any discovered planet, star or galaxy, and write a